



# 36 E Series Heavy Duty Open Element Top Range

Item: \_\_\_\_\_  
Quantity: \_\_\_\_\_  
Project: \_\_\_\_\_  
Approval: \_\_\_\_\_  
Date: \_\_\_\_\_

## Models:

☐ 36ER33

☐ 36ES33

## Six Open Element Top Range



*Model 36ER33*

## Standard Features:

- Stainless steel front and sides
- Stainless steel front rail
- Chrome plated, 4 position removable rack guides w/oven rack
- Electro-mechanical heavy-duty oven thermostat
- Six tubular elements each controlled by three-heat switches
- 3" (76mm) high stainless steel vent raiser
- Heat resistant, cool to touch oven door handle
- 6" (152mm) adjustable chrome plated legs (NSF)
- One Year limited parts & labor (USA & Canada)

## Optional Features:

- ☐ Stainless steel main back (R&S models)
- ☐ Extra oven rack
- ☐ Swivel casters complete with front brakes (4)
- ☐ 6" (152mm) adjustable stainless steel legs
- ☐ Marine equipment- storm rails for pots, hand rails, oven door latch, drip tray stop and deck fasteners

NOTE: Ranges supplied with casters must be installed with an approved restraining device.

## Specifications:

Heavy-duty electric range, Model 36ER33, with 6 element open top. Top contains six tubular elements, each controlled by 3-heat switch. Full size oven is controlled by a heavy-duty electromechanical thermostat. Oven interior is 13.5" (343mm) high x 26.25" (667mm) wide x 29" (533mm) deep with removable four-position chrome plated rack guides and one oven rack, front and rear stainless steel grease troughs. Stainless steel front and sides. Circuit breakers or fuses provide electric circuit protection. Available with casters or for dais mount. Model 36ES33 has storage base in lieu of oven section.



36 E Series Heavy Duty Open Element Top Range

MODEL	TOTAL kW	3-PHASE kW PER PHASE ALL VOLTAGES			NOMINAL AMPERES PER LINE							
					SINGLE PHASE		THREE PHASE					
							208V			240V		
		X-Y	Y-Z	X-Z	208V	240V	X	Y	Z	X	Y	Z
36ER33	19.1	6.5	4.2	8.4	92	81	62	45	54	55	40	47
36ES	12.6	4.2	4.2	4.2	61	53	35	35	35	31	31	31

CLEARANCES			
ENTRY		TO COMBUSTIBLE WALL	
CRATED	UNCRTED	SIDES	REAR*
41-1/4" (1048mm)	36-1/4" (921mm)	3" (76mm)	1/2" (13mm)

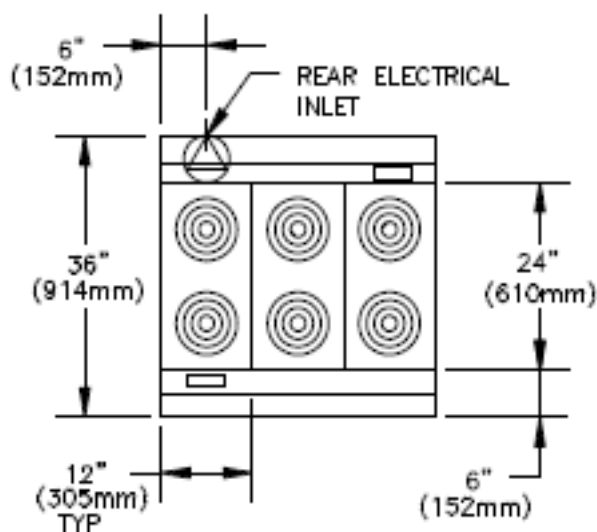

Garland products are not approved or authorized for home or residential use, but are intended for commercial applications only. Garland will not provide service, warranty, maintenance or support of any kind other than in commercial applications.

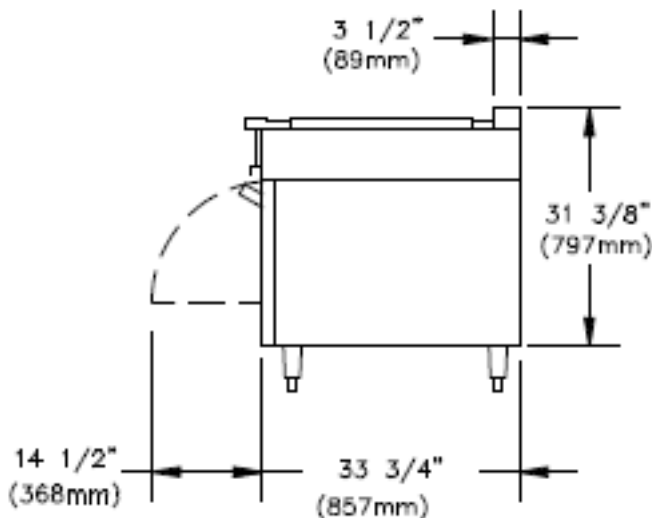
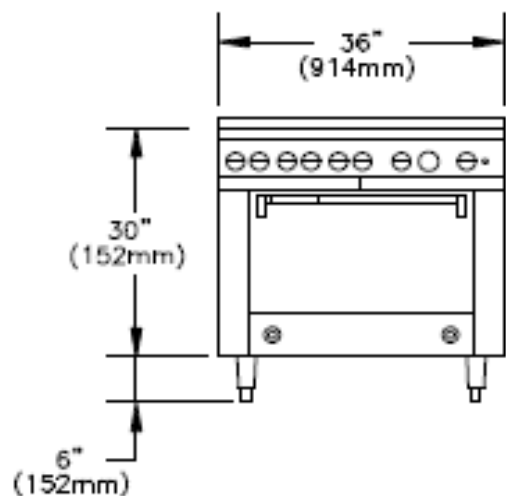

Form# 36ER33 (01/20/14)